

COMPACT SENSOR

LATHE MASTER

- Quick detection of the cutting edge position.
- Effective in reducing setup time for CNC Lathes.
- Detectable with various tool bits for external, internal and face turning.

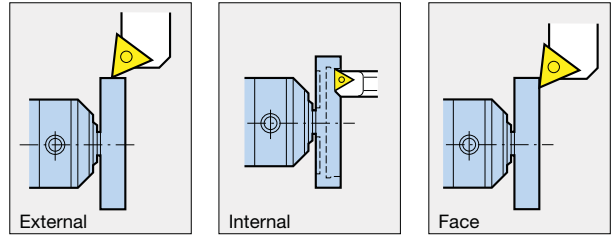

Clamp the ϕD section of LATHE MASTER with chuck jaws. LED illuminates when the tip of the tool touches the sensor plate.

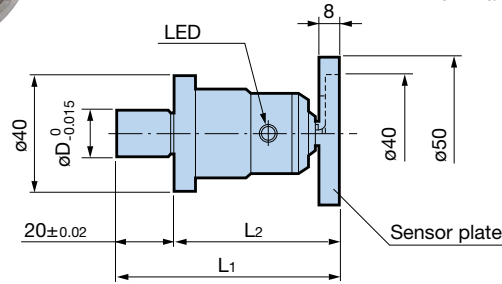

Model	ϕD	L ₁	L ₂	Repeatability	Battery
LM-15	15	75	55	±2 μm	BR425
LM-30	30	65	45		SR44 x 2

Caution

- Machine and tools must be electro-conductive for measurement.

Collar Set <Optional>

If the chuck jaw diameter does not fit, an optional collar set is available.

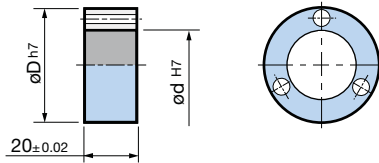

Model	Inner diameter ϕd	Outer diameter ϕD
LM15CS	15	20, 25, 30 (1 pc each)
LM30CS	30	35, 40, 45, 50 (1 pc each)

CENTERING TOOL

- Unique centering tool with superior visibility, as dial gauge always stays in front of the operator.
- Fine adjustment mechanism aids easy centering (2mm adjustment amount).
- Unrestricted mounting positions with a magnet base.
- Compact design of 90mm total length, ideal for small lathes.

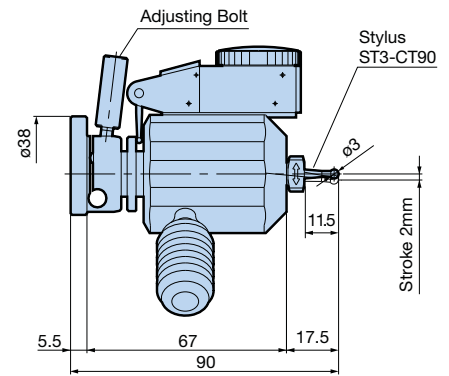
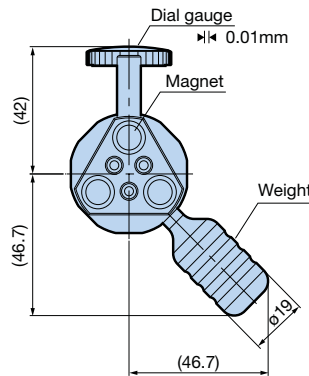
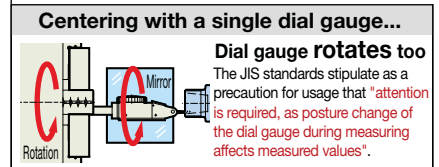
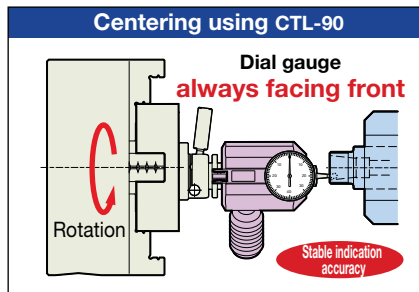

Long stylus (Optional Accessory) for CTL-90

Min. scale	0.01mm
Max. operating spindle speed	50min ⁻¹
Stroke amount	2mm
Weight	0.4kg
Standard accessory	Stylus: ST3-CT90 (tip ruby)

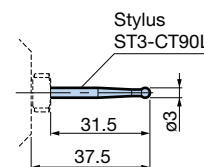

Model	ST3-CT90L
Tip:	Ruby