

# STEEL RING GAUGE



HOW TO MOVE

Master ring gauge for internal diameter measurement. A wide range of sizes are in stock while custom size ring gauge is also available upon request.

**SUB-ZERO (Cryogenic hardened) TREATMENT**  
**STABILIZATION TREATMENT**  
**LAPPED FINISH**

<p>Carbide for durable and long life ▶ Carbide Ring Gauge</p> <p><b>P71</b></p>	<p>Free from rust and corrosion ▶ Ceramic Ring Gauge</p> <p><b>P71</b></p>
<p>Non-slip and easy to handle ▶ Ring Gauge with Protective Cover</p> <p><b>P72</b></p>	<p>For Serial No. Management ▶ Laser Marking</p> <p><b>P120</b></p>
<p>Rust prevention ▶ Zerust Film for Steel</p> <p><b>P380</b></p>	



## ● DIMENSIONS

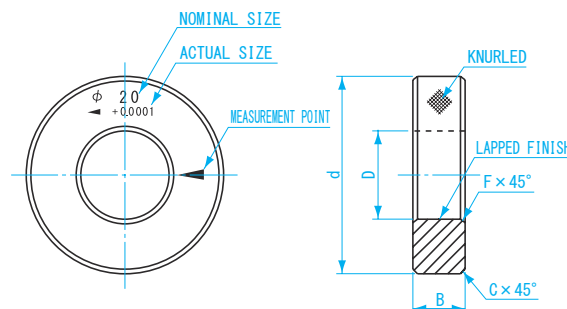

### USE

- As a master ring gauge for "0" adjustment of measuring instruments such as bore gauge, inside micrometer, dial caliper, etc.

### MATERIAL

- Alloy tool steel

### FEATURES

- Provided with inspection report

### SPECIFICATIONS

Size (mm)	Step (mm)	Out of Roundness (μm)	Diameter Inequality (μm)	Tolerance (μm)	Hardness (HV)
1 to 30	0.1 step	0.5	1.0	± 1.0	653 } 772
Over 30 to 50		0.8	1.6	± 1.5	
Over 50 to 60	0.5 step	1.0	2.0	± 2.0	
Over 60 to 80					
Over 80 to 100					
Over 100 to 200	5.0 step	2.0	4.0	± 5.0	

- Surface roughness: Within Ra0.1μm
- Squareness: 0.05 / φ100
- Parallelism: Within 0.015mm

### <Standard Size List>

Size (mm)	Step (mm)	Size (mm)
1 to 50	0.1 step	1.0•1.1•1.2•1.3•1.4•1.5•1.6•1.7•1.8•1.9•2.0•2.1•2.2•2.3•2.4•2.5•2.6•2.7.....50.0
		50.5•51.0•51.5•52.0•52.5•53.0•53.5•54.0•54.5•55.0•55.5•56.0•56.5•57.0•57.5.....100.0
Over 50 to 100	0.5 step	105.0•110.0•115.0•120.0•125.0•130.0•135.0•140.0•145.0•150.0•155.0•160.0•165.0.....200.0

### Size List

※ Reference value

Size D (mm)	Outside Diameter d (mm)	Thickness B (mm)	Chamfering for outside diameter C (mm) <sup>1)</sup>	Chamfering for inside diameter F (mm) <sup>2)</sup>	Remarks	Weight
1 to 2.5	22	4	0.4	0.3	Knurled	10g
Over 2.5 to 5		5				10g
Over 5 to 10	32	8	0.8	0.5		50g
Over 10 to 15	38	10				80g
Over 15 to 20	45	12	1.2	1.0		100g
Over 20 to 25	53	14				200g
Over 25 to 32	63	16	1.5	1.5		300g
Over 32 to 40	71	18				400g
Over 40 to 50	85	20	2.0	2.0		600~700g
Over 50 to 60	100	24				0.9~1.1kg
Over 60 to 70	112		30	1.1~1.3kg		
Over 70 to 80	125	35		1.4~1.6kg		
Over 80 to 90	140		38	1.7~1.9kg		
Over 90 to 100	160	40		2.3~2.6kg		
Over 100 to 110	180		2.4	3.7~4.1kg		
Over 110 to 120	190	2.0		4.7~5.1kg		
Over 120 to 130	200		2.0	5.0~5.5kg		
Over 130 to 140	210	2.0		5.7~6.3kg		
Over 140 to 160	230		2.0	6.6~8.2kg		
Over 160 to 180	260	2.0		8.6~10kg		
Over 180 to 200	280		2.0	9.4~11kg		