

PERIPHERALS

TOOLING MATE

[For BBT/BT SHANK]

- For mounting and removal of PULLSTUD BOLTS and tools!

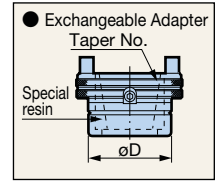
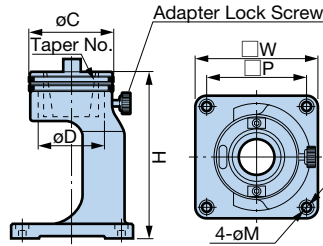

| Model | Taper No. | øC | øD | H | W | P | øM | Weight (kg) | Adapter Model |
|-----------------|-----------|-----|----|-----|-----|-----|---------------|-------------|---------------|
| TMS40-30 | 30 | 76 | 60 | 150 | 110 | 90 | 7 (for M6) | 2.6 | TMA40-30 |
| -40 | 40 | | | | | | | 2.4 | -40 |
| TMS50-40 | 40 | 105 | 88 | 190 | 160 | 130 | 9 (for M8) | 7.0 | TMA50-40 |
| -50 | 50 | | | | | | | 6.0 | -50 |

- One adapter is included with the body.
- The weight does not include the adapter.
- Adapters are also available separately.
- Adapter Lock Screw is also available separately. (Model **RTM0615**)
- Cap bolts (4 pcs) for mounting on a workbench or surface plate are not included.

Caution: Use after securely bolting to a workbench or surface plate.

[For HSK/BIG CAPTO SHANK]

- Unique needle roller clamping method.
The tool is safely fastened without damaging the taper.

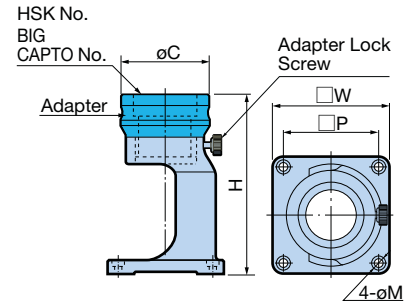

| Model | HSK No. | BIG CAPTO No. | øC | H | W | P | øM | Weight (kg) | Adapter Model |
|-------------------------------------|---------|---------------|-----|-----|-----|-----|---------------|-------------|---------------|
| TMS40-32R | 32 | C3※ | 76 | 165 | 110 | 90 | 7 (for M6) | 3.2 | TMA40-32R |
| -40R | 40 | C4※ | 76 | 165 | | | | 3.0 | -40R |
| -50R | 50 | C5※ | 76 | 165 | | | | 2.7 | -50R |
| -63R | 63 | C6※ | 87 | 172 | | | | 2.7 | -63R |
| TMS50-63R <small>NEW</small> | 63 | C6※ | 104 | 205 | 160 | 130 | 9 (for M8) | 7.1 | TMA50-63R |
| -80R | 80 | C8※ | 114 | 215 | | | | 7.1 | -80R |
| -100R | 100 | — | 124 | 219 | | | | 6.5 | -100R |

- One adapter is included with the body.
 - The weight does not include the adapter.
 - Adapters are also available separately.
 - Adapter Lock Screw is also available separately. (Model: **RTM0615**)
 - The body (blue component) is compatible with other Tooling Mates as far as the first 2 digits of the model number are identical.
 - Only BIG genuine BIG CAPTO C3 - C8 shanks can be clamped.
 - Cap bolts (4 pcs) for mounting on a workbench or surface plate are not included.
- Caution:** Use after securely bolting to a workbench or surface plate.

[Exclusive for HSK-A125 Shank]

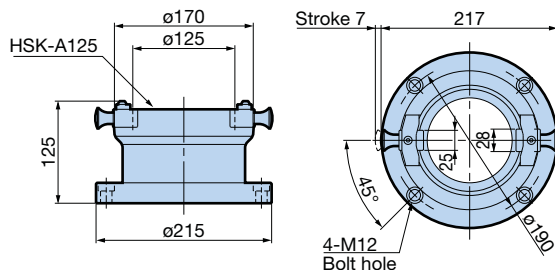

- Exclusive for HSK-A125.
 - Cap bolts (4 pcs) for mounting on a workbench or surface plate are not included.
- Caution:** Use after securely bolting to a workbench or surface plate.

| | |
|-------|---------------------|
| Model | TMS-HSK-A125 |
|-------|---------------------|