

THREAD LIMIT GAUGE (OLD JIS / GPII II •GRIR II)

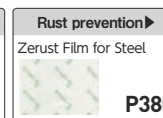

HOW TO MOVE

GO/NOGO gauge for checking accuracy of thread



Category	for Inspection
Thread Plug Gauge, Class 2	GPII II
Thread Ring Gauge, Class 2	GRIR II

● Thread limit gauge is used to perform GO/NOGO inspection based on the minimum and maximum dimensions prescribed for each screw grade.
For acceptance of a threaded part, GO gauge should thread without any difficulties and NOGO gauge should not thread more than two complete revolutions.

※ The thread category does not represent its quality but represent the position of the acceptance range.
Please select a screw gauge suitable for the product grade.

USE

- For internal / external screw thread inspection

FEATURES

- Enables to inspect whether threaded parts are within upper / lower limits of the screw's prescribed dimensional precision
- Provided with inspection report

THREAD LIMIT PLUG GAUGE (OLD JIS FOR INSPECTION CLASS 2 / GPII II)



HOW TO MOVE



THREAD LIMIT RING GAUGE (OLD JIS FOR INSPECTION CLASS 2 / GRIR II)



HOW TO MOVE



● DIMENSIONS

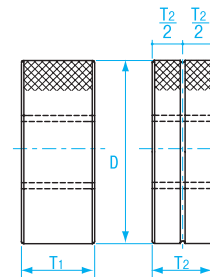

MATERIAL

- Gauge part: Alloy tool steel
- Handle part: Aluminum

● DIMENSIONS

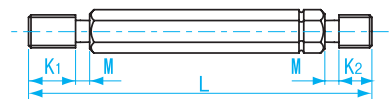

MATERIAL

- Alloy tool steel

※ Reference purposes only

Order No.	Model No.	Nominal size	K ₁ (mm)	K ₂ (mm)	M※ (mm)	L※ (mm)
370204	GPII2-0204	M2 × P0.4				
370207	GPII2-026045	M2.6 × P0.45	4.5	4.5	5.5	60
370305	GPII2-0305	M3 × P0.5				
370306	GPII2-03506	M3.5 × P0.6	6			72
370407	GPII2-0407	M4 × P0.7				
370508	GPII2-0508	M5 × P0.8			6	
370607	GPII2-06075	M6 × P0.75	8	6		74
370610	GPII2-0610	M6 × P1.0				
370710	GPII2-0710	M7 × P1.0	10			86
370810	GPII2-0810	M8 × P1.0				
370812	GPII2-08125	M8 × P1.25			7	
371010	GPII2-1010	M10 × P1.0	12			92
371012	GPII2-10125	M10 × P1.25				
371015	GPII2-1015	M10 × P1.5				
371210	GPII2-1210	M12 × P1.0		10		
371212	GPII2-12125	M12 × P1.25	16		8	105
371215	GPII2-1215	M12 × P1.5				
371217	GPII2-12175	M12 × P1.75				
371420	GPII2-1420	M14 × 2.0				
371620	GPII2-1620	M16 × 2.0	15			117
371825	GPII2-1825	M18 × 2.5			6	
372025	GPII2-2025	M20 × 2.5	22	15		129

Order No.	Model No.	Nominal size	Outside Diameter D (mm)	T ₁ (mm)	T ₂ (mm)
380204	GRIR2-0204	M2 × P0.4			
380207	GRIR2-026045	M2.6 × P0.45		3	3
380305	GRIR2-0305	M3 × P0.5	25	4	
380407	GRIR2-0407	M4 × P0.7		6	4
380508	GRIR2-0508	M5 × P0.8			
380610	GRIR2-0610	M6 × P1.0			
380710	GRIR2-0710	M7 × P1.0			
380810	GRIR2-0810	M8 × P1.0	30		
380812	GRIR2-08125	M8 × P1.25		8	6
381010	GRIR2-1010	M10 × P1.0			
381012	GRIR2-10125	M10 × P1.25			
381015	GRIR2-1015	M10 × P1.5			
381210	GRIR2-1210	M12 × P1.0	40		
381212	GRIR2-12125	M12 × P1.25		10	8
381215	GRIR2-1215	M12 × P1.5			
381217	GRIR2-12175	M12 × P1.75			
381420	GPII2-1420	M14 × 2.0		15	10
381620	GRIR2-1620	M16 × 2.0	50		
381825	GRIR2-1825	M18 × 2.5		22	15
382025	GRIR2-2025	M20 × 2.5			

Custom size limit gauges are also available on request